

One Stop Shop For All Your Progressive Cavity Pump Spare Parts

Retrofit

Based on the 30 years experience in manufacturing the Progressive cavity pumps and components, Syno knows the criticalities of the dimensions required for your pump to function smoothly without any downtime. Further endorsed by the customers, it was found that the retrofit spare parts manufactured by us function even better than that of original pump manufacturers.

Syno Parts are produced to ISO 9001:2000 using high quality materials, heat treatment processes and coatings. Strict quality procedures ensure the control of accurate manufacturing tolerances, resulting in dimensionally interchangeable parts. The process gives you increased abrasion and corrosion resistance to ensure every replacement part lasts longer, yet still offering you an economical product.



Spare Parts Available For All The Brands ... !!!

Interchangeable Spare Parts

Free-Fitting Rubber Stator



Rotors



Bonded Rubber Stator



Pump Pre-Selection Chart

Pump Model	Suction & Delivery mm.	Single Stage Pumps Max. Pressure 6 Bars			Pump Model	Suction & Delivery mm.	Double Stage Pumps Max. Pressure 12 Bars		
		Max. m ³ /Hr.	Max. Rec. Speed R.P.M.	Max. H.P.			Max. m ³ /Hr.	Max. Rec. Speed R.P.M.	Max. H.P.
D 00299	2" x 2"	4.3	1450	1.00	2D 00152	2" x 2"	2.2	1450	1.5
D 00428	2" x 2"	6.2	1450	1.50	2D 00428	2" x 2"	6.2	1450	2.0
D 00766	2" x 2"	11.1	1450	2.00	2D 00511	2" x 2"	7.4	1450	3.5
D 00855	2" x 2"	12.4	1450	2.00	2D 00766	2" x 2"	11.1	1450	4.0
D 01140	2" x 2"	10.9	960	2.00	2D 01216	2½" x 2½"	8.8	720	6.0
D 01368	2" x 2"	13.1	960	3.00	2D 02375	3" x 3"	17.1	720	12.5
D 01596	2" x 2"	15.3	960	5.00	2D 04104	4" x 4"	23.8	580	15.0
D 02933	4" x 4"	21.1	720	7.50	2D 09728	6" x 6"	35.0	360	20.0
D 04323	4" x 4"	25.0	580	10.00	Four Stage Pumps Max. Pressure 24 Bars				
D 05472	4" x 4"	31.8	580	15.00					
D 06017	6" x 6"	34.9	580	15.00					
D 06566	6" x 6"	38.1	580	15.00	4D 00152	2" x 2"	1.5	960	3.0
D 07714	6" x 6"	44.8	580	15.00	4D 00428	2" x 2"	4.1	960	4.0
D 09310	6" x 6"	44.7	480	20.00	4D 00511	2" x 2"	5.0	960	7.0
D 09880	8" x 8"	35.6	360	20.00	4D 00766	2" x 2"	5.5	720	8.0
D 11638	8" x 8"	41.9	360	20.00	4D 01216	2½" x 2½"	7.1	580	12.0
D 13832	8" x 8"	49.8	360	20.00	4D 02375	3" x 3"	13.8	580	25.0
D 16292	8" x 8"	58.6	360	25.00	4D 04104	4" x 4"	19.7	480	30.0
D 28228	8" x 8"	102.3	360	25.00	4D 09728	6" x 6"	35.0	360	40.0

The suction lifts quoted relate to water at 15°C and 762 mm barometer when operating at the lowest speeds listed. The data above is related to pumps (without circulating bypasses) for liquids of similar viscosity to water. The speeds selected in this table are for standard electric motor speed. Reduced speeds should be chosen for viscous or abrasive fluids and extreme conditions. Capacity is approximately proportional to the speed of the pump.



SYNO ENGINEERS

Head Office : K-11, Site No. 3, Panki Industrial Estate, Kanpur-208 022 (INDIA)

Tel. : +91 512 2692245, Fax : +91 512 2691660, Mob. : +91 983839 2839, +91 923559 2660

E-mail : info@synopumps.com, Web : www.synopumps.com

Authorized Distributor / Dealer :

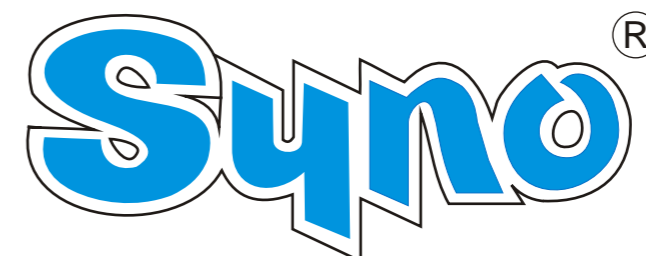

PROGRESSIVE CAVITY PUMPS

..... Since 1975

SYNO COST EFFECTIVE 'D' - SERIES



PROVEN CARDEN JOINT

- ▶ LESS INTERNAL COMPONENTS
- ▶ LONGER JOINT LIFE



OPTIMUM ROTOR-STATOR GEOMETRY

- ▶ ENSURED ZERO LEAKAGE @ LOW TORQUE
- ▶ BETTER EFFICIENCY



LESS WEAR & TEAR OF PUMP COMPONENTS

- ▶ LOW OPERATING COST
- ▶ LESS POWER CONSUMPTION



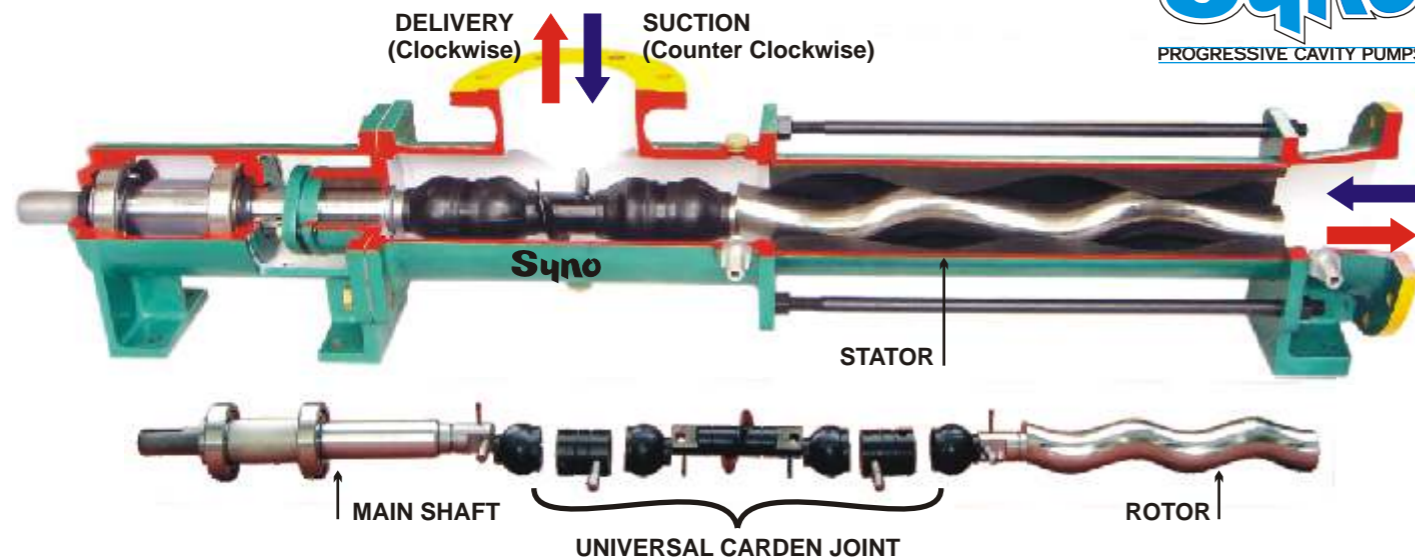

Syno Progressive Cavity Pump Cross-Section showing Internal Spare Parts

AVAILABLE MATERIAL OF CONSTRUCTION

Rotor	: Tool Steel, Stainless Steel 316	Housing Components	: Cast Iron, Stainless Steel 316
Stator	: Natural, Nitrile, High Nitrile, EPDM, Chloro - Sulphonated Rubber, Fluoro-elastomer	Special Material	: Others including Hastelloy available
Shaft & Coupling	: Stainless Steel 410/ 316	Shaft Sealing	: Gland Packing, Mechanical Seal

FLUIDS HANDLED : Acidic & Alkaline Slurry, Bentonite Slurry, Ceramic Slurry, Case in Slurry, Ferrite Slurry, Detergent Slurry, Digested Sewage Sludge, De-watered Sludge, Poly electrolytes, Sodium Silicates, Sulphited Sugar Juice, Industrial Wastes, Vegetable Oils, Printing Ink, Petroleum Jelly, Resins, Alum, Black Liquor, Magma, Coating Mix, Paint, Gum Sludge, Emulsion, Flocculent, Glue, Grout Mix, Latex, Masecuite, Viscose, Varnish, Molasses, Oil Sludge, Spent Wash, Paper Pulp, Soap Stock

INDUSTRIES: Agriculture, Edible Oil, Marine, Petro Chemical & Refineries, Sugar, Brewery & Distillery, Effluent Treatment, Malt & Cocoa, Textile, Ceramics & Refractories, Paint & Varnish, Mining, Steel, Starch, Cattle Feed, Explosives, Electronics, Sewage Treatment, Chemical & Process, Fertilizer, Rubber, Soaps & Detergent, Construction, Oil Exploration, Palm Oil, Water Treatment, Cosmetics & Toiletries, Man-made Fibre, Fisheries, Paper Pulp & Cellulose



The Carden type univeral joint used in this pump is acknowledged as being far superior to the conventional single pin & bush joint having only line contact, which is subjected to extreme concentrated load, resulting in higher wear rate. The Carden type of UJ joint employs two sets of pins perpendicular to each other, each providing freedom of angular movement which facilitates smoother transmission of angular load and also is designed to better withstand the axial forces, dominant in Progressive Cavity Pumps.

SYNO R & D Centre is the hear to SYNO spirit of translating user perspective in to tangible products & services. The development of new 'D' series small capacity pumps is yet another successful achievement of SYNO R&D Centre. Translating Concepts to Prototypes, and Prototypes into final Products, the R & D team is spear headed by some of the most qualified and experienced pump professionals. This state-of-art facility with a battery of CAD stations is also equipped with sophisticated Test beds with Data Acquisition & Analysis System that allow comprehensive validation of pump design.



'D' Series Progressive Cavity Pump is built on the robust field proven 'N' range platform retaining vital features such as the CARDAN Universal Joint and improved Rotor, Stator geometry that ensures a lower life cycle cost. This series is a culmination of SYNO's more than three decades of experience in designing, validating and manufacturing of Progressive Cavity Pumps backed by state-of-art R&D center and manufacturing infrastructure. All critical components including Rotors are manufactured in-house to close tolerances in our ISO-9001 certified manufacturing unit. From formulation to compound preparation and moulding under strict process control in our captive polymer division not only ensures superior quality of Stator but also a high degree of dimensional accuracy and repeatability.

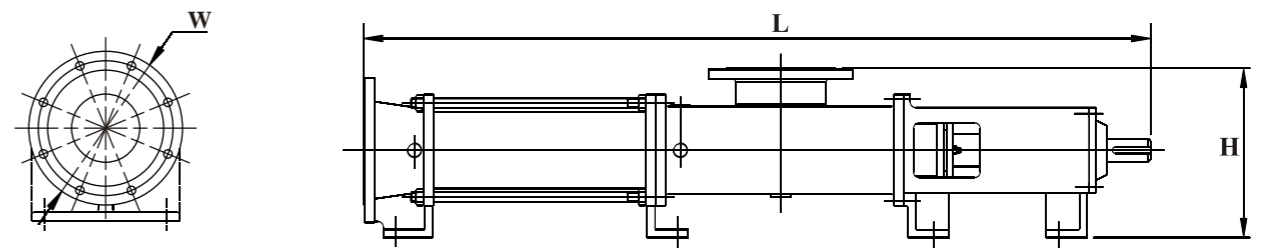

'N' Series Syno Standard Range



'VN' Series Vertical Pit Pumps



'FN' Series Wine & Beverages Pump



'SB' Series Multi Purpose Pumps

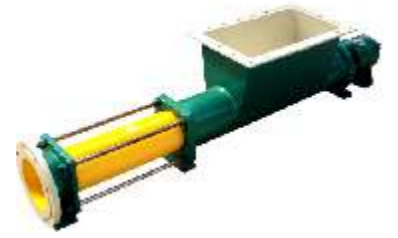

'WH' Series Large Capacity Wide Throat Pumps For Highly Viscous Fluids

Single Stage Pump				Double Stage Pump			
Model	L	B	H	Model	L	B	H
D 00299	710	100	160	2D 00152	707	100	160
D 00428	764	165	200	2D 00428	925	165	200
D 00766	812	165	200	2D 00511	899	165	200
D 00855	814	165	200	2D 00766	1042	165	200
D 01140	859	165	200	2D 01216	1060	165	200
D 01368	924	165	200	2D 02375	1418	200	268
D 01596	979	165	200	2D 04104	1331	265	310
D 02933	1278	200	268	2D 09728	1706	340	335
D 04323	1260	200	268	Four Stage Pump			
D 05472	1558	265	310				
D 06017	1440	265	310	Model	L	B	H
D 06566	1668	265	310	4D 00152	907	100	160
D 07714	1558	265	310	4D 00428	1125	165	200
D 09310	1438	265	310	4D 00511	1199	165	200
D 09880	1612	265	310	4D 00766	1272	165	200
D 11638	1778	265	310	4D 01216	1460	165	200
D 13832	1998	265	310	4D 02375	1918	200	268
D 16292	1974	265	310	4D 04104	1931	265	310
D 28228	2038	340	335	4D 09728	2506	340	335